

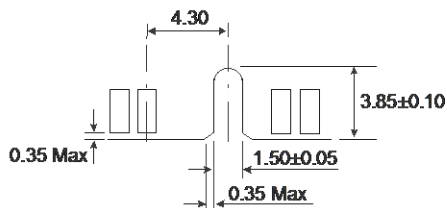

Server/Workstation offers DDR3, DDR3L and DDR4 memories, including error-correcting code DIMM (ECC DIMM) and registered DIMM (RDIMM). ECC DIMM and RDIMM are designed for workstation or server applications with the required high reliability. Both of them support ECC function to detect and correct error codes. The build-in thermal sensors help prevent the systems from overheating and further ensure stability.

- Various memory solutions including DDR3, DDR3L, and DDR4.
- JEDEC standard power supply
- Plated with 30 μ " gold finger.
- Auto refresh and self-refresh supported
- Available in standard, extended, and industrial grade temperature ranges.
- RoHS & REACH compliant.

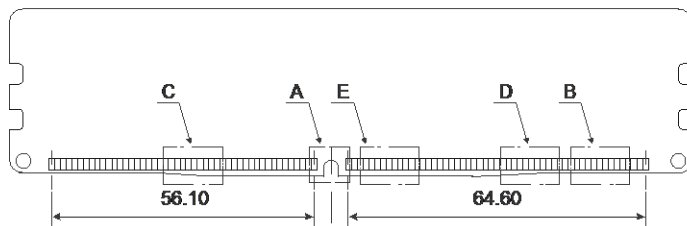
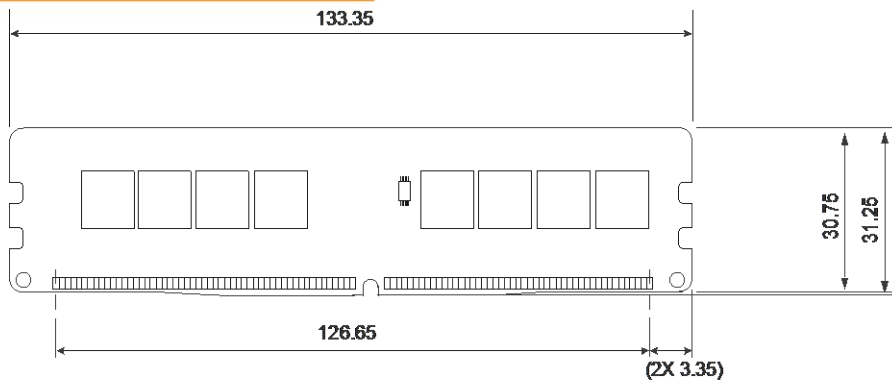

Detail A

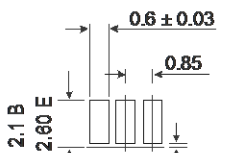
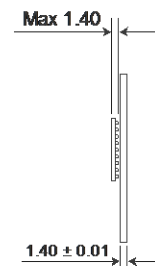

Detail B,E

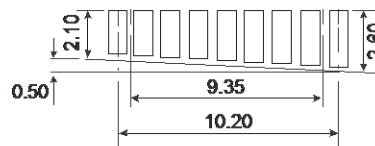

Detail C

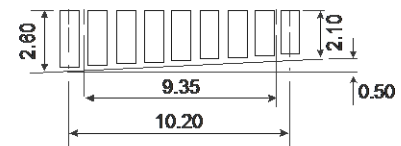

Detail D

Product Model	DDR3/DDR3L Server/Workstation	DDR4 Server/Workstation
DIMM Type	ECC DIMM / RDIMM	ECC DIMM / RDIMM
Data Rate /	1066/1333/1600/1866 MT/s	2133/2400/2666 MT/s
Density	1GB/2GB/4GB/8GB/16GB	4GB/8GB/16GB/32GB/64GB/128GB
Voltage	1.5V/1.35V	1.2V
Pin count	240-pin	288-pin
Width	72-Bit	72-Bit
PCB Height	18.75mm ~ 30.00mm	18.75mm ~ 60.00mm

MemxPro Inc.

Tel : 886- 2-8978-8997 Fax : 886-2-3393-0516 E-mail: info@memxpro.com

Address: 4F., No.32, Xiwei St., Sanchong Dist., New Taipei City, 24155, TAIWAN(R.O.C.)

Operating	0°C~+85°C/-25°C~+85°C/-40°C~+85°C	0°C~+85°C/-25°C~+85°C/-40°C~+85°C
Vibration	20G (7~2K Hz)	20G (7~2K Hz)
Shock Resistance	1500G@0.5ms	1500G@0.5ms

MemxPro Inc.

Tel : 886- 2-8978-8997 **Fax :** 886-2-3393-0516 **E-mail:** info@memxpro.com

Address: 4F., No.32, Xiwei St., Sanchong Dist., New Taipei City, 24155, TAIWAN(R.O.C.)

© MemxPro Inc. MemxPro reserves the right to change products, information and specifications without notice and is provided on an "AS IS" basis, without warranties of any kind. Products and specifications discussed herein are for reference purposes only. No license of any patent, copyright, mask work, trademark or any other intellectual property right is granted by one party to the other party under this document, by implication, estoppels or otherwise. For updates or additional information about MemxPro products, please contact MemxPro office.